

⚠ WARNING

If output setting is over 70%, the handpiece and holder can be very hot. Please be sure to turn on the auto-sleep function before use.
(On HAKKO FT-801, please be sure to connect the station and holder with included connecting cable in order for auto-sleep to function properly.)

⚠ WARNING

Operating above 80% output setting can cause stress to the heating element and shorten the life of the blades. Use 80% and above power only when necessary.
When not using the handle, be sure to place it in the holder.

⚠ CAUTION

Since the blades will become hot, place the handle on the handle holder when it is not being used.

HAKKO

THERMAL WIRE STRIPPER

**FT-8004
(with holder part)**

Thank you for purchasing HAKKO products.
When using the product, please read this manual
and follow the instruction to change the parts.

● PACKING LIST AND PART NAMES

Please make sure that all items listed below are included in the package.

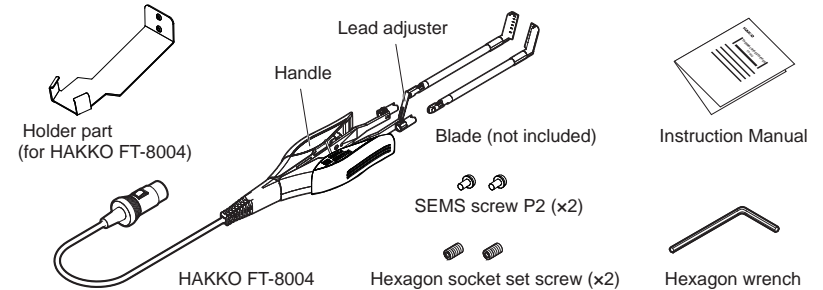

PACKING LIST

HAKKO FT-8004	1	Hexagon wrench (1.27mm)	1
Holder part (for HAKKO FT-8004)	1	Instruction Manual	1
SEMS screw P2 (M3x6)	2	Hexagon socket set screw (M2.5x2.5)	2

Precautions Regarding Electrostatic Protection

⚠ CAUTION

This product includes features such as electrically conductive plastic parts and grounding of the handle and station as measures to protect the device to be soldered from the effects of static electricity.
Be sure to observe the following instructions:

- Be sure to observe the following instructions:
- The handle and other plastic parts are not insulators, they are conductors. When replacing parts or repairing, take sufficient care not to expose live electrical parts or damage insulation materials.
- Be sure to ground the unit during use.

HAKKO
HAKKO CORPORATION

**Test Equipment
Depot**
1-800-517-8431

99 Washington Street
Melrose, MA 02176
Phone 781-665-1400
Toll Free 1-800-517-8431

Visit us at www.TestEquipmentDepot.com

● How to attach the holder part (for HAKKO FT-8004)

⚠ CAUTION

Please be sure to use the included holder part.

Remove the holder part of the handpiece holder inclusive with HAKKO FT-801.
Attach the holder part inclusive with HAKKO FT-8004.

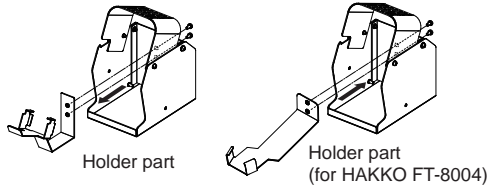

● Attaching the blades

Blades

Attaching blades

- ① Stop provisionally in the tapped hole of the handle, and do a set the hexagon socket set screw.
- ② Insert the blade so that the blade mounting flange locks into the HAKKO FT-8004. Merge type V and the V-groove of the back of the blade.

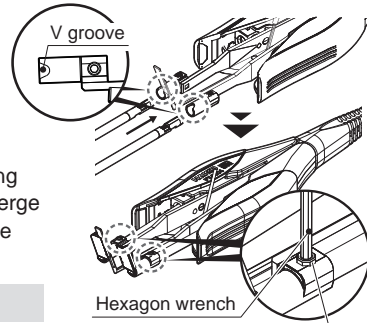

NOTE:

Blades are not heated unless both blades are inserted fully. Be sure to use the blades as a set.

- ③ Fix it with a finger so that the point of a sword does not work, tighten the hexagon socket set screw with the hexagonal wrench to secure the blades.

Hexagon socket set screw (M2.5x2.5)

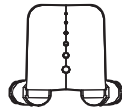

● Removing the blades

⚠ CAUTION

- When pulling out or inserting blades, be sure that the power is switched off.
- Before pulling out the blades, check that the blades have cooled down sufficiently.

Loosen and remove the hexagon socket set screw fixing the blades. As illustrated below, pull the blade straight out.



● Attaching the lead adjuster Handle

Attaching the lead adjuster

- ① Remove the insulating cover from the tip on the handle cover L-side (the side with the HAKKO logo and HAKKO FT-8004) and remove the screw from the handle cover L-side.
- ② Remove the handle cover L.
- ③ Align the lead adjuster mounting hole with the handle cover L mounting hole, replace the screw, and tighten it lightly.
- ④ Firmly fit the nail of the root side of the insulation cover in the handle cover.
- ⑤ Attach the handle cover L to the handle. Adjust the length of the lead adjuster and firmly tighten the screw.

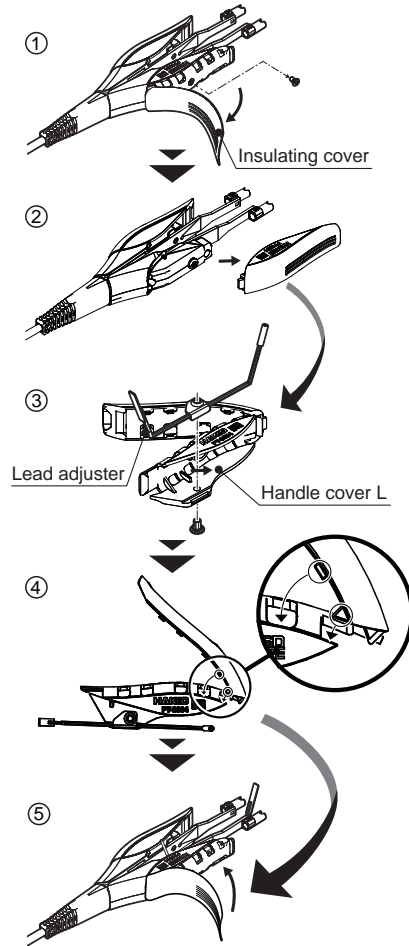

NOTE:

Pay attention to the direction of the blades when attaching the lead adjuster. (See the following figure.)

Attach the lead adjuster so that the adjuster plate end is in parallel with the blade surface.

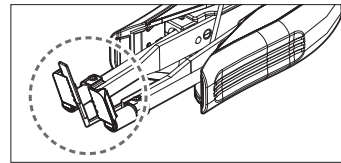

The lead adjuster can be removed with the handle cover attached to the handle.

Test Equipment Depot
1-800-517-8431

99 Washington Street
Melrose, MA 02176
Phone 781-665-1400
Toll Free 1-800-517-8431

Visit us at www.TestEquipmentDepot.com